

#### SPARE PARTS LIST

Soldering and heating insert STARLET  
Type of gases: propane, methane, MAPP

#### LISTE DES PIÈCES DE RECHANGE

Inserte de brasage et chauffage STARLET  
Type de gaz: propane, méthane, MAPP

#### LISTA DE REQUERSTOS

Inserto de soldadura y calentamiento STARLET  
Tipo de gas: propano, metano, MAPP

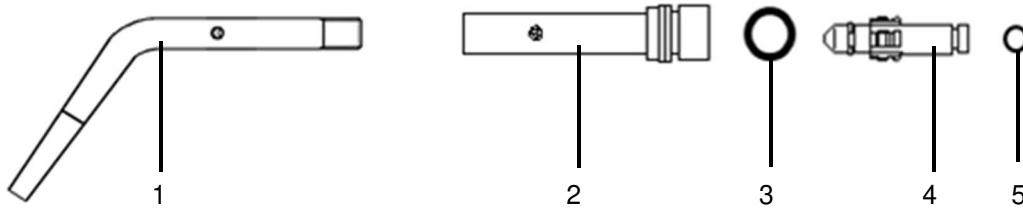

| Pos.<br>Item<br>Pos. | Benennung<br>Description<br>Désignation<br>Nombre  | Sach. Nr. / Art. no.<br>No. d'article / Art. No. |                  |                  |
|----------------------|--|--|------------------|------------------|
|                      |  | Z - PMY<br>Gr. 1                                 | Z - PMY<br>Gr. 2 | Z - PMY<br>Gr. 3 |
| 1 - 5                | <b>Löt- und Wärmeinsatz STARLET</b><br>Soldering and heating insert STARLET<br>Inserte de brasage et chauffage STARLET<br>Inserto de soldadura y calentamiento STARLET | 716.06491  | 716.06492        | 716.06493        |
| 1                    | <b>Wärmdüse mit Mischrohr</b><br>Heating nozzle with mixing pipe<br>Buse de chauffage avec tube mélangeur<br>Tobera de calentamiento con tubo de mezcla                | 716.06481  | 716.06482        | 716.06483        |
| 2                    | <b>Mischdüse</b><br>Mixing nozzle<br>Buse de mélange<br>Boquilla de mezclado   | 716.01901  | 716.01902        | 716.01903        |
| 3                    | <b>O-Ring 11 x 2</b><br>O-ring<br>Joint torique<br>Junta tórica  | 0.329.527  | →                | →                |
| 4                    | <b>Druckdüse</b><br>Pressure nozzle<br>Buse de pression<br>Boquilla de presión   | 716.05180  | 716.05181        | 716.05182        |
| 5                    | <b>O-Ring 5 x 1,5</b><br>O-ring<br>Joint torique<br>Junta tórica   | 673.29059  | →                | →                |

| Pos.<br>Item<br>Pos. | Benennung<br>Description<br>Désignation<br>Nombre  | Sach. Nr. / Art. no.<br>No. d'article / Art. No. |                  |                  |
|----------------------|--|--|------------------|------------------|
|                      |  | Z - PMY<br>Gr. 4                                 | Z - PMY<br>Gr. 5 | Z - PMY<br>Gr. 6 |
| 1 - 5                | <b>Löt- und Wärmeinsatz STARLET</b><br>Soldering and heating insert STARLET<br>Inserte de brasage et chauffage STARLET<br>Inserto de soldadura y calentamiento STARLET | 716.06494  | 716.06495        | 716.06496        |
| 1                    | <b>Wärmdüse mit Mischrohr</b><br>Heating nozzle with mixing pipe<br>Buse de chauffage avec tube mélangeur<br>Tobera de calentamiento con tubo de mezcla                | 716.06484  | 716.06485        | 716.06486        |
| 2                    | <b>Mischdüse</b><br>Mixing nozzle<br>Buse de mélange<br>Boquilla de mezclado   | 716.01904  | 716.06478        | 716.06479        |
| 3                    | <b>O-Ring 11 x 2</b><br>O-ring<br>Joint torique<br>Junta tórica  | 0.329.527  | →                | →                |
| 4                    | <b>Druckdüse</b><br>Pressure nozzle<br>Buse de pression<br>Boquilla de presión   | 716.05183  | 716.06476        | 716.05184        |
| 5                    | <b>O-Ring 5 x 1,5</b><br>O-ring<br>Joint torique<br>Junta tórica   | 673.29059  | →                | →                |

Bitte Reparaturanleitung beachten  
Please follow the repair instructions  
Veuillez respecter les intructions de reparacion  
Rogamos prestar atencion a las instrucciones de reparaci3n

Änderungen vorbehalten  
Subject to alteration  
Droit de modification reserve  
Salvo modification

MESSER Cutting Systems GmbH  
Otto-Hahn-Str. 2-4  
D-64823 Groß-Umstadt  
Tel.: +49 (0) 6078 787-0  
Fax: +49 (0) 6078 787-150  
E-Mail: [info@messer-cutting.com](mailto:info@messer-cutting.com)

© Messer Cutting Systems  
® = registriertes Warenzeichen  
Quality management system